

- REFERENCIAS:
- EJE PROYECTO
 - LINEA ELECTRICA
 - CUNETA DERECHA
 - CUNETA IZQUIERDA

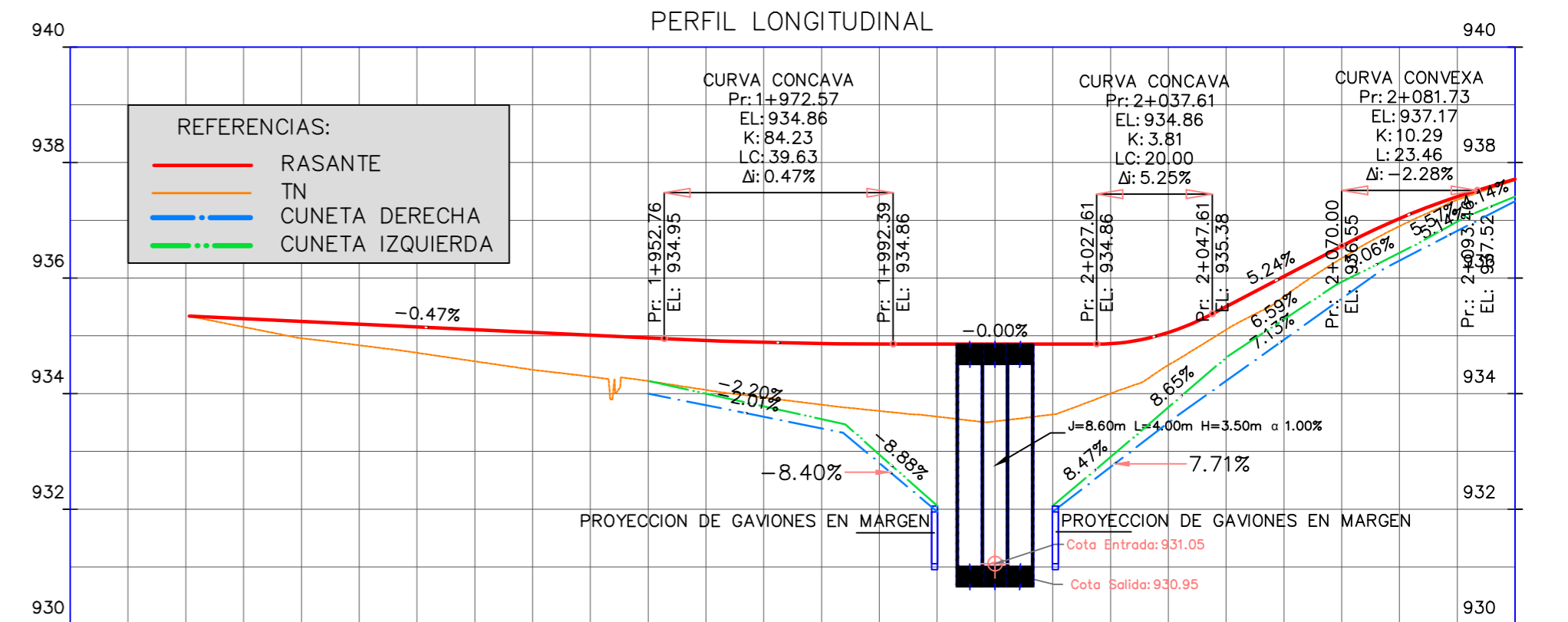

PROGRESIVA	E:11 1+850.00	E:12 1+875.00	E:13 1+900.00	E:14 1+925.00	E:15 1+940.00	E:16 1+950.00	E:17 1+975.00	E:18 2+000.00	E:19 2+010.00	E:20 2+020.00	E:21 2+030.00	E:22 2+040.00	E:23 2+050.00	E:24 2+060.00	E:25 2+070.00	E:26 2+080.00	E:27 2+090.00	E:28 2+100.00
DISTANCIA	25.00	25.00	25.00	15.00	10.00	25.00	25.00	10.00	10.00	10.00	10.00	10.00	10.00	10.00	10.00	10.00	10.00	
COTA TERRENO		935.25	934.84	934.49	934.29	934.22	933.87	933.60	933.52	933.64	934.00	934.49	935.11	935.68	936.34	936.90	937.35	937.69
COTA PROYECTO		935.32	935.20	935.08	935.01	934.96	934.88	934.86	934.86	934.86	934.86	935.06	935.51	936.03	936.55	937.03	937.41	937.71
DIFERENCIA		-0.07	-0.36	-0.60	-0.72	-0.75	-1.01	-1.26	-1.34	-1.22	-0.86	-0.56	-0.40	-0.35	-0.21	-0.13	-0.05	0.02

SIGNIFICADO DE NUMEROS	①	②	③
	④	⑤	⑥
	⑦	⑧	⑨

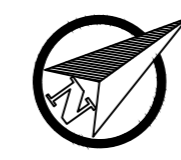
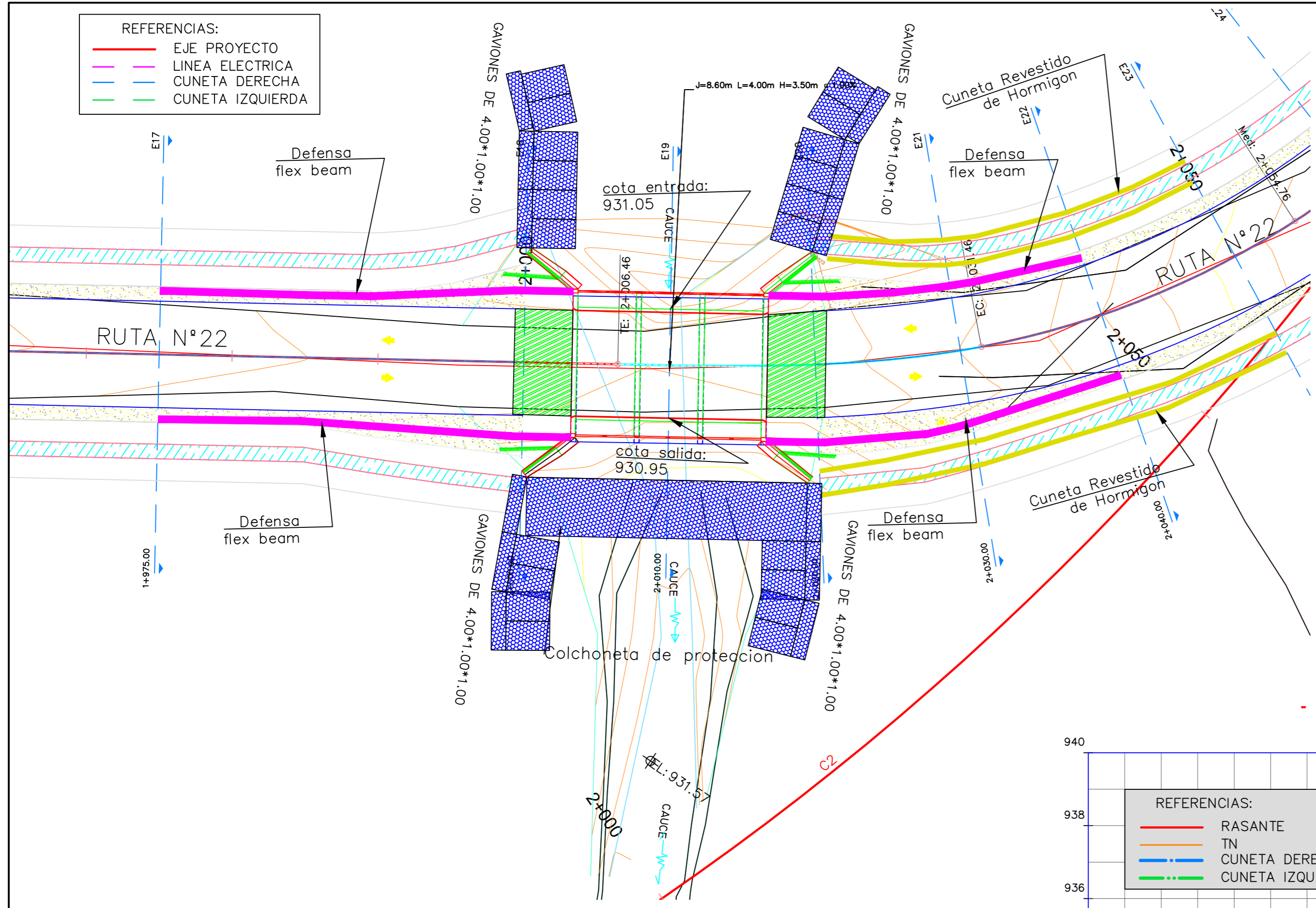

DIRECCION PROVINCIAL DE VIALIDAD - JUJUY

LAMINA N° 1

PLANIALTIMETRIA

OBRA : ALCANTARILLA SOBRE RIO HONDO TRAMO : Ruta Provincial N°22
 SECCION : Empalme R.N. N°66 - Empalme R.P.N° 1
 PROGRESIVAS : 1+850.00 - 2+100.00 ESC. H. 1:1000 ESC. V. 1:100 JULIO - 2022

DIBUJO:
D.C. J. L. Aramayo
ESTUDIO
M.M.O. Carlos Robles
PROYECTO:
Ing. Dan Tarcaya